

V:C2 & V:P2 VA-AFO TRI SET ASSEMBLY MANUAL

▲ This set DOES NOT include Profile Design extension bar.

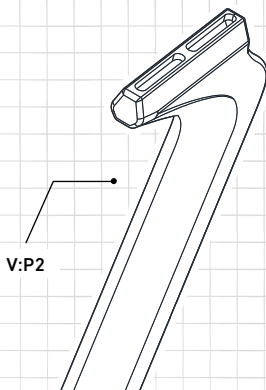
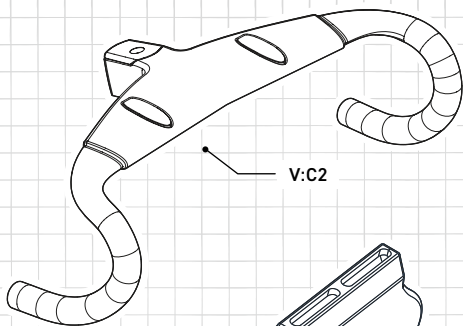

DARE

INTRODUCTION

Thank you for choosing the DARE VA-AFO Tri Set.

This set allows you to upgrade your VA-AFO into an entry-level triathlon bike capable of mounting the Profile Design ASC PRO integrated carbon aero extensions. This manual will guide you through the correct installation of the V:C2 aero handlebar and V:P2 seatpost, ensuring your VA-AFO delivers both aerodynamic efficiency and comfort during long-distance triathlon races.

We strongly recommend undergoing a professional fitting before purchasing this upgrade set, and having it installed by a certified mechanic to ensure optimal performance and safety. Please follow the instructions in this manual carefully, and use the specified torque values and proper tools. Correct installation and regular maintenance will guarantee maximum benefit from your upgrade kit in both races and training.

Please note: The extension bar system for this Tri set is the Profile Design ASC PRO (A3 system), which is NOT included. You may purchase it directly from the official Profile Design website (profile-design.com) or from your local dealers.



V:C2 & V:P2
VA-AFO Tri Set
繁體中文說明手冊

SET COMPONENTS

V:C2 TRI AERO COCKPIT

Size: 90*360 / 90*380 /
100*360 / 100*380 / 100*400 /
120*380 / 120*400 mm

Material: Toray® carbon fiber

- An optional carbon computer mount is available for the V:C2. This mount can be used to attach both cycling computer and action camera.



V:C2
detail info



More computer
mounts accessories

V:P2 TRI AERO SEATPOST

Size: 350 mm

Material: Toray® carbon fiber

- * Please refer to the official website for the latest size specifications.

INSTRUCTIONAL SYMBOLS



Warning

Potentially dangerous, could cause serious harm or fatalities if not avoided.

- * Warning symbols mean that if the situation is not properly handled, it could result in accident or injury. Even if this manual does not specifically mention fatalities, the risk is always present.



Notice

Assembly tips or cautionary advice, will not cause injury but could result in broken parts.



10 Nm

Allen Key Size and Torque Value

If a diagram specifies an Nm value, that means a torque wrench must be used to ensure the correct torque is applied (for example, the diagram may specify to use a 4mm Allen wrench at 10Nm)



Greasel



Carbon Paste



Loctite

1 V:C2 ASSEMBLY

For more assembly details, please refer to the VA-AFO Assembly Manual.

Applicable DARE Model: VA-AFO

Compatible Extension Bar: Profile Design ASC PRO (A3 system)



VA-AFO
assembly manual

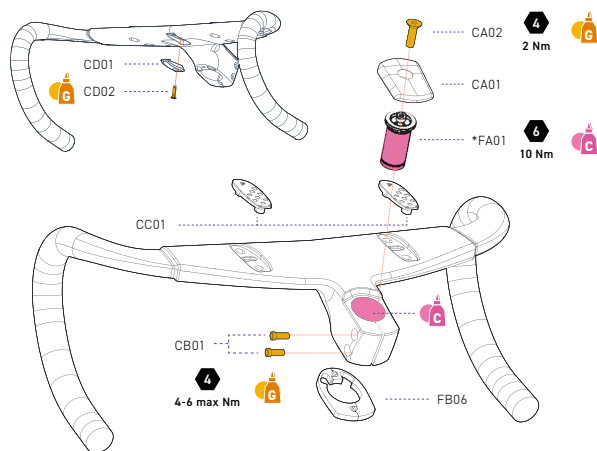

No.	Item Name	Qty	No.	Item Name	Qty
CA01	Stem top cap	1	CD01	Computer mount cover	1
CA02	Stem flat screw M6 * 35 * 31.5 mm	1	CD02	Stem flat screw M4 * 16 * 12 mm	1
CB01	Stem socket screw M5 * 21 * 16 mm	2	FB06	5mm headset spacer	10
CC01	Extensions mount cover	2	*FA01	Plug expander	1
			*Frame set accessory, not included in this set.		

Extension Bar Purchase & Assembly

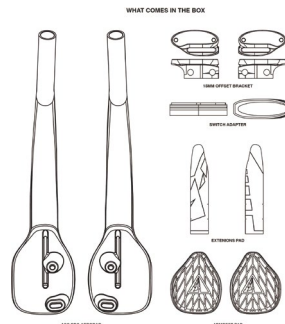

i The ASC PRO extension bar should be purchased through the official Profile Design website or an authorized dealer, and assembled according to the official assembly instructions.



ASC PRO
website



ASC PRO assembly
instructions

i The total angle range of the ASC Pro installed on the V:C2 is 10°~20° (ASC Pro body is +15°, adjustable via -5° to +5° angle spacers).

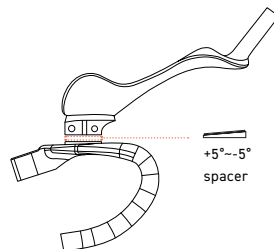

A3 spacer
installation

Extension Bar Shifter Suggestion

- i** V:C2 can only be equipped with wireless shifting systems.
We recommend the following controllers for ASC PRO:



VA-AFO with SRAM Groupset

Please purchase the SRAM eTap AXS Wireless Blips (EC-BLIP-B1) . This wireless shifter button is compatible and comes with a clip that can be directly mounted onto the ASC PRO.

or



VA-AFO with Shimano Groupset

We recommend the SHIMANO SW-RS801-E Di2 single-button shifter for ASC PRO. This shifter is “wired-compatible,” and the cable length will vary depending on the spacer height of the ASC PRO. Please confirm with your assembly mechanic before purchasing. The button supports shifters at the R8170 series or higher and includes a clip for direct installation on the ASC PRO.



2 V:P2 ASSEMBLY

The V:P2 is the dedicated seatpost for the VA-AF0, offering greater forward extension adjustments for triathlon cockpit setups compared to the standard seatpost, V:P1.

V:P1 provides a ± 15 mm adjustment range based on a clamp center baseline of 0 mm. V:P2 provides forward extension adjustment from +45 mm to +75 mm.

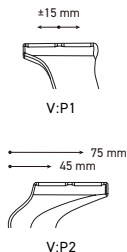

Installation in VA-AF0

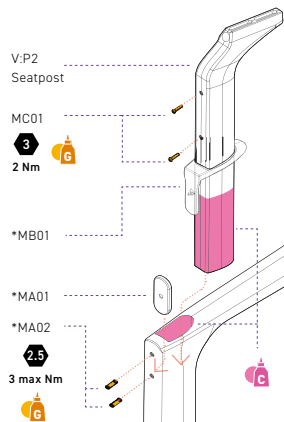

No.	Item Name	Qty
MC01	Bottle cage stainless round screw M5 * 15 * 12 mm	2
*MA01	Magnetic seatpost clamp	1

Step 2.1 Place the [MB01] seatpost waterproof cover on top of the V:P2 seatpost.

2.2 [MA01] is a magnetic hidden clip that attaches to the inner rear wall of the seat tube.

2.3 After inserting the V:P2 seatpost, it can be secured with the [MA02] headless screw. Maximum torque is 3 Nm.

No.	Item Name	Qty
*MA02	Seatpost clamp set screw M5 * 10 * 10 mm	2
*MB01	Seatpost waterproof cover	1
*Frame set accessory, not included in this set.		

⚠ The seatpost clamp must be tightened to the specified torque, if it is too loose the seatpost may move around, if it is too tight the carbon fiber may crack or become stuck and unable to be removed.

i V:P2 must be inserted to a minimum depth of 90mm, make sure to reach at least 90mm for a stable connection.

Saddle Clamp

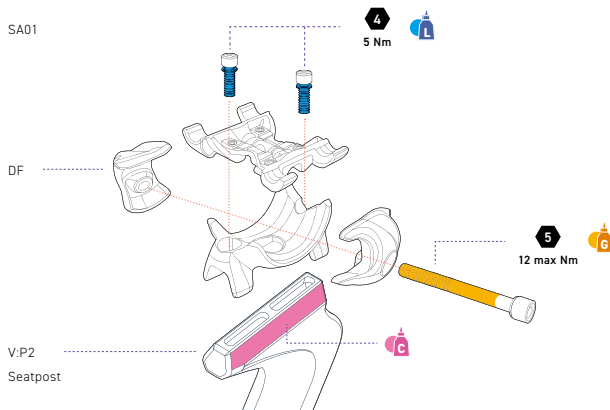

⚠ Tighten the front and rear setback bolts to 5 Nm. Regularly check the torque on both setback and seat rail clamp bolts.

i Use the appropriate seat rail clamp for your rail material. The frameset comes with carbon rail inserts (DF). For metal rail inserts (CF), please contact an official DARE retailer.

No.	Item Name	Qty
SA01	Saddle clamp kit	1

WARRANTY

With the proof of purchase, DARE grants a warranty period of one year beginning on the date of purchase. If shop delivery date is not shown on the proof of purchase, we will refer to the date of purchase.



Product
registration

The proof of purchase must state the date of purchase, product name, amount paid, and must be stamped by the retailer. If the proof of purchase is damaged or lost, warranty cannot be granted. To protect your rights, we suggest you complete the warranty process after receiving the product, and please keep your receipt or proof of purchase (must state the date of purchase, product name, amount paid and must be stamped by the retailer). If you have lost any of the documents above, please ask the original place of purchase for assistance. Otherwise, your product will be considered out of warranty.

Please note that the warranty is limited to products purchased from and assembled by DARE authorized dealers. If you have any warranty issue, please contact your dealer first. You can find a list of authorized dealers at: www.dare-bikes.com/retailer

If your concerns cannot be resolved through our official dealers, you may contact us directly via email at: service@dare-bikes.com

